

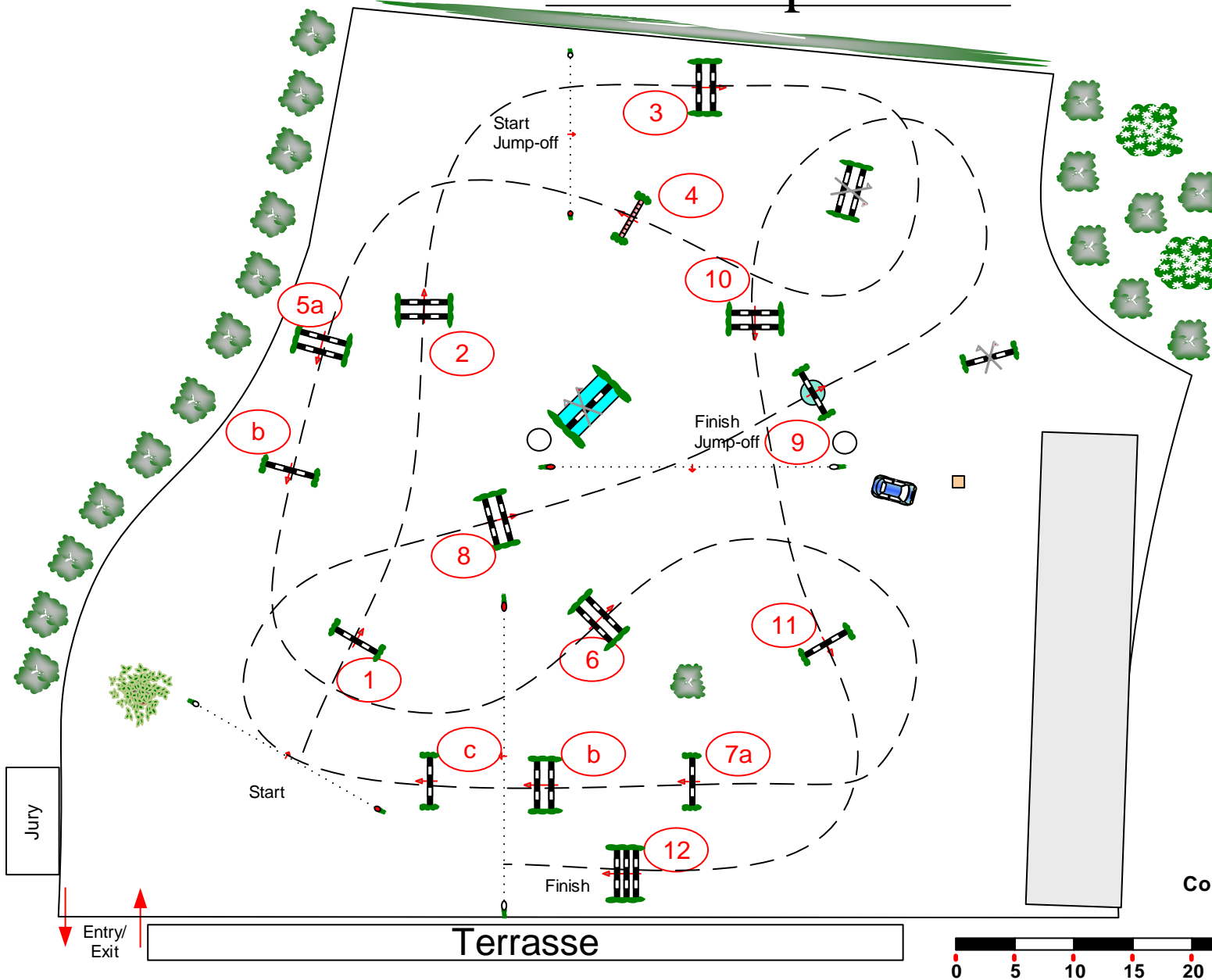

CSI-CH/J/U25-A/CSI1*/CSIYH1*

Eschweiler Young Masters

23.-26. April 2015



Class No.: **5**

CSI* Gold Tour Final

Competition with one jump-off

Samstag, 25. April 2015

Start: 16:00

Table: A
 National RG:
 FEI RG / Art. 238.2.2
 Height: 1,30 m

Speed: 375 m/min

Length: 460 m

Time allowed: 74 sec

Time limit: 148 sec

1st Jump-off:

3, 4, 5a, 6, 7a, 7b, 9, 10

Length: 290 m

Time allowed: 47 sec

Time limit: 94 sec

Obstacles: 12 Jump-off: 7

Efforts: 15 Jump-off: 8

Course Designer: Matthias Rosellen/GER & Team